

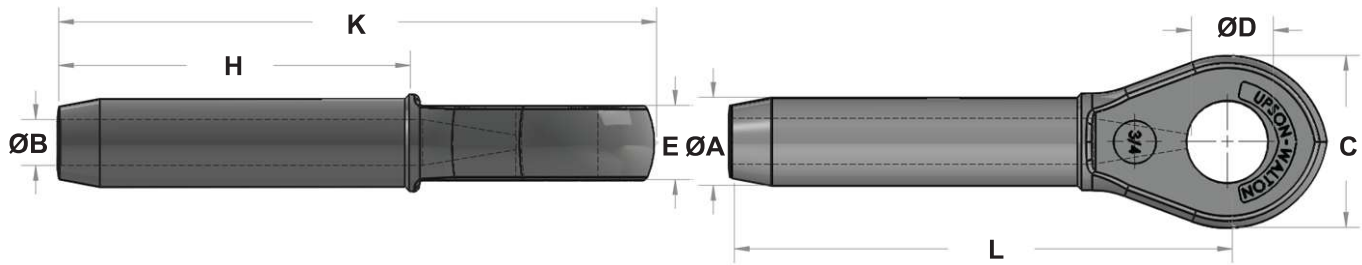

# Closed Swage Sockets - Carbon Steel



Stock No.	Rope Size	Dimensions								Weight lbs. Each	After Swage Min - Max
		A	B	C	D	E	H	K	L		
41025002	1/4	0.495	0.272	1-7/16	0.750	1/2	2-1/8	4-3/8	3-1/2	0.35	0.428 - 0.460
41031302	5/16	0.770	0.339	1-11/16	0.875	11/16	3-3/16	5-1/2	4-1/2	0.77	0.678 - 0.710
41037502	3/8	0.770	0.406	1-11/16	0.875	11/16	3-3/16	5-1/2	4-1/2	0.73	0.678 - 0.710
41043802	7/16	0.982	0.484	2	1.063	7/8	4-1/4	6-15/16	5-3/4	1.47	0.865 - 0.910
41050002	1/2	0.982	0.547	2	1.063	7/8	4-1/4	6-15/16	5-3/4	1.38	0.865 - 0.910
41056302	9/16	1.257	0.609	2-1/2	1.250	1-1/8	5-5/16	8-3/4	7-1/4	2.90	1.115 - 1.160
41062502	5/8	1.257	0.672	2-1/2	1.250	1-1/8	5-5/16	8-3/4	7-1/4	2.80	1.115 - 1.160
41075002	3/4	1.545	0.796	3	1.438	1-5/16	6-3/8	10-3/8	8-5/8	5.16	1.365 - 1.420
41087502	7/8	1.700	0.938	3-1/2	1.688	1-1/2	7-7/16	12-1/8	10-1/8	7.40	1.490 - 1.550
41100002	1-0/0	1.975	1.062	4	2.063	1-3/4	8-1/2	13-3/4	11-1/2	11.20	1.740 - 1.800
41112502	1-1/8	2.245	1.188	4-1/2	2.313	2	9-9/16	15-1/4	12-3/4	16.00	1.990 - 2.050
41125002	1-1/4	2.525	1.328	5	2.563	2-1/4	10-5/8	17-1/4	14-3/8	22.70	2.240 - 2.300
41137502	1-3/8	2.800	1.453	5-1/4	2.563	2-1/4	11-11/16	18-7/8	15-3/4	29.00	2.490 - 2.560
41150002	1-1/2	3.075	1.578	5-1/2	2.813	2-1/2	12-3/4	20-3/8	17	37.50	2.740 - 2.810
41175002	1-3/4	3.385	1.859	6-3/4	3.563	3	14-7/8	24	20	55.70	2.990 - 3.060
41200002	2-0/0	3.935	2.109	7-3/4	3.813	3-1/4	17	27-1/2	23	90.00	3.490 - 3.560
41225002	2-1/4	4.450	2.360	8-5/8	4.312	4	19-1/8	29-3/4	24-7/8	125.00	3.950 - 4.020
41250002	2-1/2	4.930	2.657	8-5/8	4.312	4	19-5/8	31-1/8	26-1/4	142.00	4.350 - 4.420
41300002	3-0/0	5.960	3.166	9-1/4	5-5/16	5-3/8	23-3/4	37-3/4	32-1/8	252.00	5.240 - 5.310

### CAUTION

Carbon Steel Closed Swage Sockets are recommended for use on 6 x 19 or 6 x 37 IPS or XIP, (EIP), XXIP (EEIP) IWRC regular lay ropes. Before using Swage Sockets with any other type lay, construction, or grade of wire rope, or strand, it is recommended that a test assembly be destructively tested to prove the adequacy of the assembly.

