

STARPOINT eye nut VRM-M12

Artikel-Nr: 7990312



- Lifting points pivots 360° for an easy adjustment in load direction.
- Clear marking of the minimum WLL for all loading directions.
- The WLL statement corresponds to the minimum WLL in all loading directions. Higher WLL possible when location and installation is optimised (compare WLL chart).
- Available as: – Standard Metric Thread M6-M30 (DIN EN 13)
- Special coating on request.
- Component according to the test criterias of BG/DGUV “GS-OA-15-04”.
- Quick and easy installation with just one bolt connection.
- Hand tightening with appropriate wrench is sufficient for a singular lift.

Other important RUD specific information and specialities to our RUD lifting points can be found in the specific user instruction.

STARPOINT eye nut VRM-M12

Artikel-Nr: 7990312

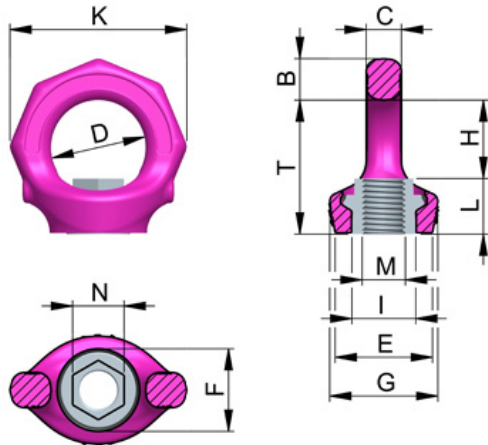

weight	0.18 kg	0.40 lbs
Nominal WLL	750 kg	1650 lbs
T	42 mm	1-21/32"
B	13 mm	1/2"
C	10 mm	3/8"
D	30 mm	1-3/16"
E	30 mm	1-3/16"
F	24 mm	15/16"
G	34 mm	1-11/32"
H	25 mm	63/64"
I	19,8 mm	25/32"
K	56 mm	2-3/16"
L	17 mm	43/64"
M	M12 mm	M12
N	14 mm	9/16"